

JUPITER NORTH
FOR
ANDCLIFFE DEVELOPMENT CO.

VEGETATION - ASSESSMENT

THE PROPERTY FOR THE PROPOSED JUPITER NORTH DEVELOPMENT IS DEVOID OF SIGNIFICANT VEGETATION. THIS FINDING WAS VERIFIED BY THE COUNTY AT THE TIME OF THRESHOLD REVIEW.

THE MAJORITY OF THE SITE IS COVERED WITH GRASSES AND SPARSE GROUNDS OF RAILROAD VINE AND BEACH SUNFLOWER. A FEW SEAGRAPE PLANTS AND NECKLACE POD PLANTS EXIST IN THE AREAS EAST OF THE COASTAL CONSTRUCTION SETBACK LINE; THESE PLANTS WILL REMAIN UNTOUCHED DURING AND AFTER DEVELOPMENT. TWO CABBAGE PALMS EXIST ON THE SITE NEAR THE RIGHT-OF-WAY AND WILL BE TRANSPLANTED TO THE WEST OF S.R. 707 AS PART OF THE BUFFER LANDSCAPING. THE EXISTING COCONUT PALM IN THE CENTER OF THE SITE WILL BE REMOVED BECAUSE OF CONCERN ABOUT ITS CONTRACTING LETHAL YELLOWING. THE EXISTING INVASIVE EXOTICS INCLUDING THE AUSTRALIAN PINE AND BRAZILIAN PEPPER WILL BE REMOVED AS REQUIRED BY THE COUNTY.

THERE ARE NO EXISTING PROTECTED SPECIES OR SPECIMEN TREES ON THE SITE AND THEREFORE NO SALVAGING WILL BE DONE.

A 25% SET ASIDE AREA WILL NOT BE PROVIDED ON THE SITE.

THE CLEARING ACTIVITIES ON THE SITE WILL BEGIN ONCE A BUILDING PERMIT IS RECEIVED. AT THIS TIME THE DURATION OF CONSTRUCTION HAS NOT BEEN DETERMINED.

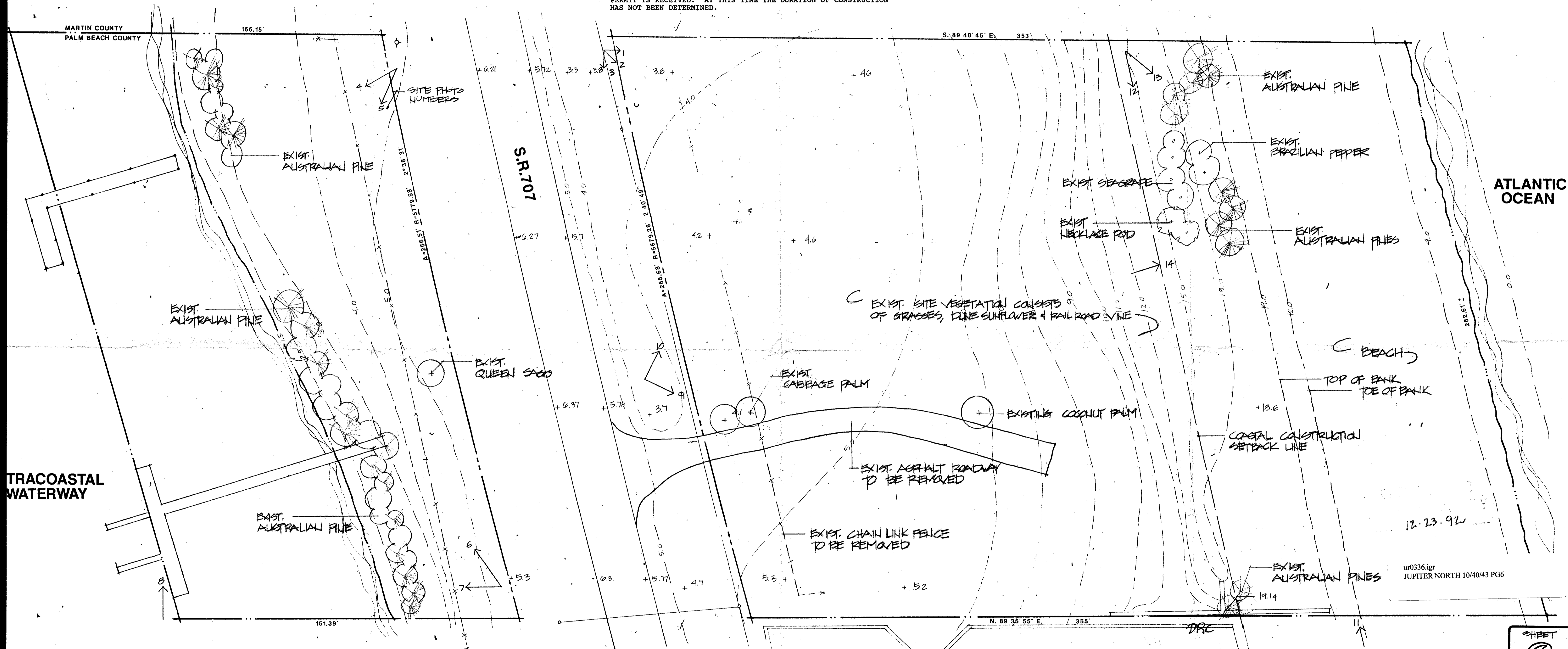

12.23.92
ur0336.igr
JUPITER NORTH 10/40/43 PG6

EXISTING CONDITIONS & VEGETATION PLAN

SHEET
6
OF 6

OWNER:
OTTO B DIVOSTA AND BETTY J. DIVOSTA PARTNERSHIP
4500 P.G.A. BLVD., SUITE 400
PALM BEACH GARDENS, FLORIDA 33418
407-627-2112

DEVELOPER:
R. MASON SIMPSON
SANDCLIFFE DEVELOPMENT COMPANY
25 SADDLEBACK ROAD
TEQUESTA, FLORIDA 33469
407-744-2000

PLANNER/LANDSCAPE ARCHITECT:
JOHN R. AREND
THE EVANS GROUP
1030 NORTH ORANGE AVE., SUITE 200
ORLANDO, FLORIDA 32801
407-849-6310

ENGINEER:
MICHAEL B. SCHORAH P.E.
MICHAEL B. SCHORAH & ASSOCIATES, INC.
1850 FOREST HILL BLVD.
WEST PALM BEACH, FLORIDA 33406
407-968-0080

ENVIROSCAPE
LAND PLANNING & LANDSCAPE ARCHITECTURE
A DIVISION OF THE EVANS GROUP

1030 N. ORANGE AVE., SUITE 200
ORLANDO, FLORIDA 32801
407-849-6310
FAX 407-649-3078

